

### FLEX-PRO® M-3 & M-4

- 10,000:1 Turndown ratio
- Tube Failure Detection
- Revolution Count Display & Alarm
- Brushless DC Motor
- NEMA 4X (IP 66) Washdown
- NSF Listed Std. 61
- 5 Year Warranty



Model M-324-MNK

Model M-424-BNL

Sold and serviced exclusively by highly skilled, factory authorized technicians.



NEMA 4X

Patents: 4,496,295, 7,001,153, 8,418,364 and other patents pending

#### Applications:

- Municipal Water Treatment
- Municipal Wastewater Treatment
- Chemical Metering
- Chlorination
- Chloramination
- Fluoridation
- Polymer Injection
- Acid Injection
- Alum Injection
- PAC Injection
- Caustic Injection

#### Features:

- Peristaltic pump design does not have valves that can clog requiring maintenance.
- Self priming - even against maximum line pressure. By-pass valves are not required. Cannot vapor lock or lose prime.
- Output rates to: 158.5 GPH (600 LPH) and pressures to 125 PSI (8.6 Bar).
- 10,000:1 turndown ratio with high resolution motor speed adjustment.
- No maintenance brushless variable speed motor.
- Specially engineered tubing for long life at high pressures.
- Patented Tube Failure Detection (TFD) system. Senses tube failure by detecting chemical in the pump head. No false triggering from condensation or washdown.
- Control Inputs include: 4-20mA, 0-10Vdc, and Pulse inputs for remote external speed or batch control and 0-30 VDC / contact closure remote start/stop.
- Revolution count display with user programmable alarm set-point for tube maintenance.
- VGA Graphic multi-color backlit LCD displays remote/local control status, motor speed, output rate, input signal values, service and alarm status in three easy to see colors.
- Outputs include: Scalable 4-20mA or pulse, one 250V/6A relay and three 115V/1A contact closures assignable to monitor various pump functions including TFD, FVS, revolution counter, remote/local, forward/reverse, input signals, output signals, motor on, motor fault, operating mode setting, and others.
- Two molded squeeze rollers and two alignment rollers provide factory calibrated optimum squeeze for unparalleled accuracy and extra long tube life.
- Heavy duty rotor - single piece plastic rotor means no flexing and increased accuracy with no metal springs or hinges to corrode.
- Inject at maximum pressure in either direction (clockwise or counter clockwise).
- Compatible with Blue-White's output Flow Verification Sensor (FVS) system.

### Engineering Specifications:

**Maximum working pressure (excluding pump tubes):**

125 psig (8.6 bar)

Note: see individual pump tube assembly maximum pressure ratings.

**Maximum Fluid temperature (excluding pump tubes):**

185°F (85°C)

Note: see individual pump tube assembly maximum temperature ratings.

**Ambient Operating Temperature**

14°F to 115°F (-10°C to 46°C)

**Ambient Storage Temperature**

-40°F to 158°F (-40°C to 70°C)

**Operating Voltage:**

A3 MODELS:

115VAC/60Hz, 1ph (2.0 Amp Maximum)

230VAC/60Hz, 1ph (1.0 Amp Maximum)

220VAC/50Hz, 1ph (1.0 Amp Maximum)

240VAC/50Hz, 1ph (1.0 Amp Maximum)

A4 MODELS:

115VAC/60Hz, 1ph (3.1 Amp Maximum)

230VAC/60Hz, 1ph (1.6 Amp Maximum)

220VAC/50Hz, 1ph (1.6 Amp Maximum)

240VAC/50Hz, 1ph (1.6 Amp Maximum)

**Power Cord Options:**

115V60Hz = NEMA 5/15 (USA)

230V60Hz = NEMA 6/15 (USA)

220V50Hz = CEE 7/II (EU)

240V50Hz = AS 3112 (Australia/New Zealand)

**Enclosure:**

NEMA 4X (IP66), Polyester powder coated aluminum.

Maximum Overall Dimensions:

M-3 models: 8-1/8"W x 10-3/4"H x 15-1/4"D (20.6W x 27.3H x 38.9D cm)

M-4 models: 12-1/8"W x 14-1/4"H x 18-5/8"D (30.8W x 36.1H x 47.3D cm)

### Materials of Construction:

Wetted components:

**Pump Tube Assembly (Model Specific - 2 provided):**

**Tubing:** . . . . . Flex-A-Prene®, Flex-A-Chem®, or Flex-A-Thane®

**Adapter fittings:** .PVDF

**Recommended Ancillary Items Sold Separately:****Injection / Back-flow Check valve:**

**Body & insert:** . . . . . PVDF

**Check Ball:** . . . . . Ceramic

**Spring:** . . . . . Hastelloy C-276

**Ball Seat O-ring:** . . . . . TFE/P (optional EP)

**Static Seal O-ring:** . . . . . TFE/P (optional EP)

**For "S" tubing type connections only:**

(Available on M3 only)

**Suction Tubing:** . . . . . 3/8" OD x 1/4" ID x 10' Clear PVC

**Discharge Tubing:** . . . . . 3/8" OD x 1/4" ID x 10' Polyethylene (LLDPE)

**Suction Strainer:** . . . . . PVDF

**For "B" barb tubing and "M" M/NPT connections only:**

(Available on ND, NKL, NGG, NEE, G2G and M-4 only)

**Suction Strainer:**

**Body:** . . . . . PVDF

**Check Ball:** . . . . . Ceramic

**Ball Seat O-ring:** . . . . . TFE/P (optional EP)

**For "C" Tri-clamp and "Q" Quick Disconnect connections\* only:**

(Available on ND, NKL, NGG, NEE, and G2G only)

**Suction Strainer:** . . . . . PVDF

\*Quick Disconnect Valves sold separately

**Approximate shipping wt:**

M-3 models: 33 lb. (15.0 Kg)

M-4 models: 58 lb. (26.3 Kg)

**Motor:**

Brushless DC, 1/4 H.P.

**Motor speed adjustment range**

10,000:1 (0.01% - 100% motor speed)

**Motor speed adjustment resolution**

0.1% increments > 10% motor speed

0.01% increments > 1% motor speed and < 10%

0.001% increments < 1% motor speed

**Maximum viscosity**

12,000 Centipoise

**Maximum suction lift:**

30 ft. Water, 0 psig (9.14 m, 0 bar)

**Display**

3 color VGA backlit LCD, UV resistant.

**Display resolution**

0.0 > 10% motor speed

0.00 > 1% motor speed and < 10%

0.000 < 1% motor speed

**Display languages**

English, Spanish, French or German selectable.

**Keypad**

Eleven button positive action tactile switch keypad.

**Security**

Programmable 4-digit password.

Non-Wetted components:

**Enclosure:**

413 Aluminum (Polyester powder coated)

**Pump Head:**

Valox® (PBT) thermoplastic

**Pump Head Cover:**

Polycarbonate for added strength and chemical resistance.

Permanently lubricated sealed motor shaft support ball bearing.

**Cover Screws:**

Stainless Steel

**Roller Assembly:**

**Rotor:**.....Valox® (PBT)

**Rollers:**.....PVDF/Nylon

**Roller Bearings:**.....SS Ball Bearings

**Motor Shaft:**

Chrome plated steel

**TFD System Sensor pins:**

Hastelloy C-276

**Power Cord:**

3 conductor, SJTW-A Water-resistant

**Tube Installation Tool:**

Glass Filled Nylon

**Mounting Brackets and Hardware:**

316 Stainless Steel

**Output Specifications:**

Output Range			Max Speed	Max Pressure	Max Temperature	M-3 Model Numbers		
<b>Flex-A-Prene® M-3 Tube Pumps</b>								
Listed under NSF Std. 61   Meets FDA criteria for food   Excellent chemical resistance   CIP   SIP								
GPH	LPH	ML/MIN	RPM	PSI (bar)	F (C)	115V AC	230V AC	220V AC
.0002 - 2.10	.0007 - 7.92	.0132 - 132	125	125 (8.6)	185 (85)	M-324-*ND	M-325-*ND	M-326-*ND
.0025 - 25.3	.0096 - 96.0	.1596 - 1596	125	125 (8.6)	185 (85)	M-324-*NJ	M-325-*NJ	M-326-*NJ
.0033 - 33.3	.0126 - 126	.2100 - 2100	125	125 (8.6)	185 (85)	M-324-*NK	M-325-*NK	M-326-*NK
.0033 - 33.3	.0126 - 126	.2100 - 2100	125	30 (2.1)	185 (85)	M-324-*NKL	M-325-*NKL	M-326-*NKL
<b>Flex-A-Prene® M-3 Tube Pumps</b>								
Listed under NSF Std. 61   Meets FDA criteria for food   Excellent chemical resistance   Extra long life at low pressures								
GPH	LPH	ML/MIN	RPM	PSI (bar)	F (C)	115V AC	230V AC	220V AC
.0004 - 4.76	.0018 - 18.0	.03 - 300	125	110 (7.6)	185 (85)	M-324-*NEE	M-325-*NEE	M-326-*NEE
.0019 - 19.02	.0072 - 72.0	.12 - 1200	125	110 (7.6)	185 (85)	M-324-*NGG	M-325-*NGG	M-326-*NGG
<b>Flex-A-Chem® M-3 Tube Pumps</b>								
Listed under NSF Std. 61   Meets FDA criteria for food   Superior chemical resistance								
GPH	LPH	ML/MIN	RPM	PSI (bar)	F (C)	115V AC	230V AC	220V AC
.0015 - 15.06	.0057 - 57.0	.0950 - 950	125	50 (3.4)	130 (54)	M-324-*TH	M-325-*TH	M-326-*TH
.0028 - 28.5	.0108 - 108	.18 - 1800	125	50 (3.4)	130 (54)	M-324-*TK	M-325-*TK	M-326-*TK
<b>Flex-A-Thane® M-3 Tube Pumps</b>								
Meets FDA criteria for food   Resistant to oils, greases and fuels								
GPH	LPH	ML/MIN	RPM	PSI (bar)	F (C)	115V AC	230V AC	220V AC
.0004 - 4.60	.0017 - 17.4	.0290 - 290	125	65 (4.5)	130 (54)	M-324-*GE	M-325-*GE	M-326-*GE
.0010 - 10.1	.0038 - 38.4	.0637 - 637	125	65 (4.5)	130 (54)	M-324-*GG	M-325-*GG	M-326-*GG
.0024 - 24.9	.0094 - 94.2	.1570 - 1570	125	65 (4.5)	130 (54)	M-324-*GH	M-325-*GH	M-326-*GH
.0028 - 28.5	.0108 - 108	.1800 - 1800	125	65 (4.5)	130 (54)	M-324-*GK	M-325-*GK	M-326-*GK
.002 - 18.23	.007 - 69.0	.115 - 1150	125	65 (4.5)	130 (54)	M-324-*G2G	M-325-*G2G	M-326-*G2G
Output Range			Max Speed	Max Pressure	Max Temperature	M-4 Model Numbers		
<b>Flex-A-Prene® M-4 Tube Pumps</b>								
Listed under NSF Std. 61   Meets FDA criteria for food   Excellent chemical resistance   CIP   SIP								
GPH	LPH	ML/MIN	RPM	PSI (bar)	F (C)	115V AC	230V AC	220V AC
.0028 - 28.5	.0108 - 108	.180 - 1800	125	125 (8.6)	185 (85)	M-424-*NH	M-425-*NH	M-426-*NH
.0044 - 44.4	.0168 - 168	.280 - 2800	125	100 (6.9)	185 (85)	M-424-*NJ	M-425-*NJ	M-426-*NJ
.0054 - 54.4	.0204 - 204	.3400 - 3400	125	65 (4.5)	185 (85)	M-424-*NHHL	M-425-*NHHL	M-426-*NHHL
.0050 - 50.7	.0192 - 192	.320 - 3200	125	80 (5.5)	185 (85)	M-424-*NK	M-425-*NK	M-426-*NK
.0054 - 54.0	.0204 - 204	.340 - 3400	125	100 (6.9)	185 (85)	M-424-*NHH	M-425-*NHH	M-426-*NHH
.010 - 100.0	.0378 - 378	.630 - 6300	125	50 (3.4)	185 (85)	M-424-*NL	M-425-*NL	M-426-*NL
.015 - 158.5	.0600 - 600	1.00 - 10000	125	30 (2.1)	185 (85)	M-424-*NP**	M-425-*NP**	M-426-*NP**
<b>Flex-A-Chem® M-4 Tube Pumps</b>								
Listed under NSF Std. 61   Meets FDA criteria for food   Superior chemical resistance								
GPH	LPH	ML/MIN	RPM	PSI (bar)	F (C)	115V AC	230V AC	220V AC
.0054 - 54.00	.0204 - 204	.3400 - 3400	125	30 (2.1)	130 (54)	M-424-*TK	M-425-*TK	M-426-*TK
.0126 - 126.0	.0477 - 477.0	.800 - 8000	125	30 (2.1)	130 (54)	M-424-*TKK	M-425-*TKK	M-426-*TKK
<b>Flex-A-Thane® M-4 Tube Pumps</b>								
Meets FDA criteria for food   Resistant to oils, greases and fuels								
GPH	LPH	ML/MIN	RPM	PSI (bar)	F (C)	115V AC	230V AC	220V AC
.0039 - 39.6	.0150 - 150	.250 - 2500	125	65 (4.5)	130 (54)	M-424-*GH	M-425-*GH	M-426-*GH
.0055 - 55.5	.0210 - 210	.350 - 3500	125	65 (4.5)	130 (54)	M-424-*GK	M-425-*GK	M-426-*GK
.010 - 100.0	.0378 - 378	.630 - 6300	125	65 (4.5)	130 (54)	M-424-*GKK	M-425-*GKK	M-426-*GKK

\* Inlet/outlet connection types available: **S** = 3/8" OD x 1/4" ID flexible tubing with compression type connections (M-3 models only), **M** = 1/2" male NPT **B** = 1/2" ID tubing barb type connections (ND, NKL, NEE, NGG, G2G, and M-4 models only), **C** = 3/4" tri-clamp connections (ND, NKL, NEE, NGG, and G2G only), **Q** = Quick Disconnect (M-3 models: ND, NKL, NEE, NGG, and G2G only, and M-4 single Flex-A-Prene® tube models only) (Valves sold separately)

\*\*NP flow rate reduced 16.5% with Quick Disconnect connections.

Note: output volumes based on testing with water at 72 degrees F, 5 foot suction lift, atmospheric conditions at sea level.

Engineering and Technical Data

**Chemical Resistance of Tubing:**

<b>Flex-A-Prene® Tubing</b>			
Meets FDA criteria for food   Excellent chemical resistance			
Alcohol general	Citric Acid 50%	Hydrochloric acid 33%	Potassium hydroxide
Aluminum Sulfate (Alum)	Ethylene glycol	Hydrocyanic acid	Propylene glycol
Ammonium chloride	Ferric chloride	Hydrogen peroxide	Sodium hydroxide 50%
Ammonium hydroxide	Ferric nitrate	Hypochlorous acid	Sodium Bisulfite
Ammonium Sulfate (LAS)	Ferric sulfate	Iodine	Sodium Chlorite 12%
Benzyl alcohol	Ferrous chloride - 43% in water	Magnesium chloride	Sodium Hypochlorite 12.5%
Bleach	Ferrous sulfate	Magnesium sulfate	Sodium sulfide
Brine solutions	Fluosilicic Acid (up to 25%)	Phosphoric acid	Sulfuric acid up to 50%
Calcium Hydroxide 10% (Lime Slurry)	Formic acid	Plating solutions	Tannic acid
Calcium hypochlorite 20%	Glucose	Polyaluminum Chloride (PAC)	

<b>Flex-A-Chem® - Ultra smooth plasticizer-free bore (inner liner)</b>			
Meets FDA criteria for food   Superior chemical resistance			
Ferrous Chloride (up to 40%)	Phosphoric Acid (up to 85%)	Bases	Applications: Ink and solvent production Battery acid filling Specialty chemical production / processing Sensitive fluid transfer
Fluoboric Acid (up to 48%)	Potassium Permanganate (up to 6%)	Salts	
Fluosilicic Acid (up to 25%)	Potassium Hypochlorite (up to 70%)	Ketones	
Hydrofluoric Acid (up to 48%)	Sodium Phosphate (up to 30%)	Alcohols	
Nitric Acid (up to 71%)	Sulfuric Acid (up to 98%)	Isobutyl Alcohol	

<b>Flex-A-Thane® Tubing</b>			
Meets FDA criteria for food   Resistant to oils, greases and fuels			
Cyclohexane	Kerosene	Oils:	Oils:
Diesel Fuel	Lard	ASTM reference No.1,2,3	Linseed
Fatty acids	Mineral spirits	Castor	Lubricating
Gasoline	Soap solutions	Coconut	Mineral
Heptane	Turpentine	Fuel	
Hexane			

**Pump Tube Assembly Output Specifications:**

<b>Model M-3 - Available Pump Tubes and Output Ranges</b>							
Tube Material	Tube Size	Max Output Pressure	Max Temp	Required Roller Part Number	Output Range		
Material	Code	PSI (bar)	F (C)		GPH	LPH	ML/Min
Flex-A-Prene	ND	125 (8.6)	185 (85)	A3-SND-R	.0002 - 2.10	.0007 - 7.92	.0132 - 132
Flex-A-Prene	NEE	110 (7.6)	185 (85)	A3-SNGG-R	.0004 - 4.76	.0018 - 18.0	.03 - 300
Flex-A-Prene	NGG	110 (7.6)	185 (85)	A3-SNGG-R	.0019 - 19.02	.0072 - 72.0	.12 - 1200
Flex-A-Prene	NJ	125 (8.6)	185 (85)	A3-SNGG-R	.0025 - 25.3	.0096 - 96.0	.1596 - 1596
Flex-A-Prene	NK	125 (8.6)	185 (85)	A3-SNGG-R	.0033 - 33.3	.0126 - 126	.2100 - 2100
Flex-A-Prene	NKL	30 (2.1)	185 (85)	A3-STH-R	.0033 - 33.3	.0126 - 126	.2100 - 2100
Flex-A-Chem	TH	50 (3.4)	130 (54)	A3-STH-R	.0015 - 15.06	.0057 - 57.0	.0950 - 950
Flex-A-Chem	TK	50 (3.4)	130 (54)	A3-SNGG-R	.0028 - 28.5	.0108 - 108	.18 - 1800
Flex-A-Thane	GE	65 (4.5)	130 (54)	A3-SGE-R	.0004 - 4.60	.0017 - 17.4	.0290 - 290
Flex-A-Thane	GG	65 (4.5)	130 (54)	A3-SGE-R	.0010 - 10.1	.0038 - 38.4	.0637 - 637
Flex-A-Thane	GH	65 (4.5)	130 (54)	A3-SGE-R	.0024 - 24.9	.0094 - 94.2	.1570 - 1570
Flex-A-Thane	GK	65 (4.5)	130 (54)	A3-SGE-R	.0028 - 28.5	.0108 - 108	.1800 - 1800
Flex-A-Thane	G2G	65 (4.5)	185 (85)	A3-SGE-R	.002 - 18.23	.007 - 69	.115 - 1150

<b>Model M-4 - Available Pump Tubes and Output Ranges</b>							
Tube Material	Tube Size	Max Output Pressure	Max Temp	Required Roller Part Number	Output Range		
Material	Code	PSI (bar)	F (C)		GPH	LPH	ML/Min
Flex-A-Prene	NH	125 (8.6)	185 (85)	A4-MNH-R	.0028 - 28.5	.0108 - 108	1800 - 1800
Flex-A-Prene	NJ	100 (6.9)	185 (85)	A4-MNH-R	.0044 - 44.4	.0168 - 168	2800 - 2800
Flex-A-Prene	NHHL	65 (4.5)	185 (85)	A4-MNH-R	.0054 - 54.0	.0204 - 204	3400 - 3400
Flex-A-Prene	NK	80 (5.5)	185 (85)	A4-MNH-R	.0050 - 50.7	.0192 - 192	3200 - 3200
Flex-A-Prene	NHH	100 (6.9)	185 (85)	A4-MNH-R	.0054 - 54.0	.0204 - 204	3400 - 3400
Flex-A-Prene	NL	50 (3.4)	185 (85)	A4-MNL-R	.0100 - 100.0	.0378 - 378	6300 - 6300
Flex-A-Prene	NP*	30 (2.1)	185 (85)	A4-MNL-R	.0158 - 158.5	.0600 - 600	1.00 - 10000
Flex-A-Chem	TK	30 (2.1)	130 (54)	A4-MTH-R	.0054 - 54.00	.0204 - 204	3400 - 3400
Flex-A-Thane	GH	65 (4.5)	130 (54)	A4-MGH-R	.0039 - 39.6	.0150 - 150	2500 - 2500
Flex-A-Thane	GK	65 (4.5)	130 (54)	A4-MGH-R	.0055 - 55.5	.0210 - 210	3500 - 3500
Flex-A-Thane	GKK	65 (4.5)	130 (54)	A4-MGH-R	.0100 - 100.0	.0378 - 378	6300 - 6300

\*NP flow rate reduced 16.5% with Quick Disconnect connection.

### Dimensions:

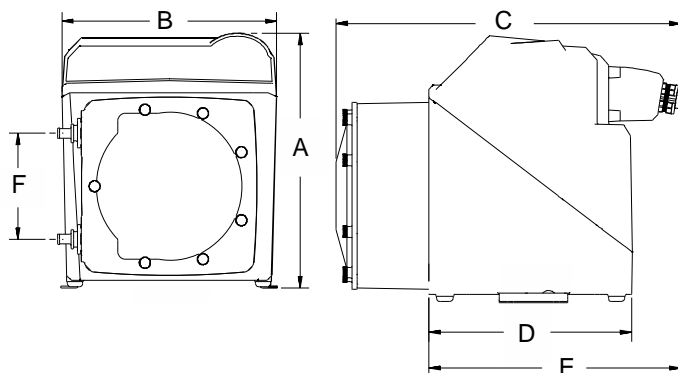

Dim	M-3 Series		M-4 Series	
	Inches	cm	Inches	cm
A	10-3/4"	27.3	14-1/4"	36.1
B	8-1/8"	20.6	12-1/8"	30.8
C	15-1/4"	38.9	18-5/8"	47.3
D	10"	25.4	11"	27.9
E	12-1/4"	31.0	13-5/8"	34.6
F	4-1/4"	10.7	6"	15.2

### Model Number Matrix:

M	Flex-Pro® ProSeries-M® Model Number		
	<b>Maximum Output Range</b>		
<b>3</b>	Flex-Pro M-3 maximum output 35.19 GPH(133.2 LPH)		
<b>4</b>	Flex-Pro M-4 maximum output 158.5 GPH (600 LPH)		
	<b>Maximum Motor Speed</b>		
<b>2</b>	125 RPM (maximum rotor rotation speed)		
	<b>Power Cord (operating voltage requirement 96VAC to 264VAC)</b>		
<b>4</b>	115V / 60Hz, power cord NEMA 5/15 plug (US)		
<b>5</b>	230V / 60Hz, power cord NEMA 6/15 plug (US)		
<b>6</b>	220V / 50HZ, power cord CEE 7/VII plug (EU)		
<b>8</b>	240V / 50HZ, power cord AS 3112 plug (Australia/New Zealand)		
<b>9</b>	230V / 50HZ, power cord BS 1363 plug (UK)		
<b>X</b>	No Power Cord		
	<b>Inlet/Outlet Connection Size, Connection Type, Connection Material</b>		
<b>S</b>	3/8" OD x 1/4" ID Tube Compression Fitting, Natural PVDF (Kynar), available for M-3 models only		
<b>M</b>	1/2" Male NPT Fitting, Natural PVDF (Kynar), available for M-3 and M-4 models		
<b>B</b>	1/2" ID Tubing Barb Fitting, Natural PVDF (Kynar), available for ND, NKL, NEE, NGG, G2G and M-4 models only		
<b>C</b>	1/2" - 3/4" Tri-clamp connections, Natural PVDF (Kynar), available for ND, NKL, NEE, NGG, and G2G only		
<b>Q</b>	Quick Disconnect, Natural PVDF (Kynar), M-3 models: ND, NKL, NEE, NGG, and G2G only, and M-4 single Flex-A-Prene® tube models only, NP flow rate reduced 16.5% with Quick Disconnect connections (Valves sold separately)		
<b>MB</b>	1/2" Male BSPT Fitting, Natural PVDF (Kynar), available for M-3 and M-4 models		
	<b>Pump Tube Material, Pump Tube Size</b>		
<b>ND</b>	Flex-A-Prene® .075 ID, M-3 models only	<b>TK</b>	Flex-A-Chem® .375 ID
<b>NH</b>	Flex-A-Prene® .250 ID - M-4 models only	<b>TKK</b>	Flex-A-Chem® .375 ID (Dual Tube), M-4 models only
<b>NHL</b>	Flex-A-Prene® .250 ID (65 PSI max pressure - longer life) M-4 only	<b>GE</b>	Flex-A-Thane® .125 ID, M-3 models only
<b>NHH</b>	Flex-A-Prene® .250 ID (Dual Tube), M-4 models only	<b>GG</b>	Flex-A-Thane® .187 ID, M-3 models only
<b>NJ</b>	Flex-A-Prene® .312 ID	<b>GH</b>	Flex-A-Thane® .250 ID
<b>NK</b>	Flex-A-Prene® .375 ID	<b>GHH</b>	Flex-A-Thane® .250 ID (Dual Tube), M-4 models only
<b>NKL</b>	Flex-A-Prene® .375 ID (30 PSI max pressure - longer life)	<b>GK</b>	Flex-A-Thane® .375 ID
<b>NL</b>	Flex-A-Prene® .500 ID, M-4 models only	<b>GKK</b>	Flex-A-Thane® .375 ID (Dual Tube), M-4 models only
<b>NP</b>	Flex-A-Prene® .750 ID, M-4 models only	<b>NEE</b>	Flex-A-Prene® .093 ID (Dual Tube), M-3 models only
<b>TH</b>	Flex-A-Chem® .250 ID	<b>NGG</b>	Flex-A-Prene® .187 ID (Dual Tube), M-3 models only
<b>NHHL</b>	Flex-A-Prene® .250 ID (65 PSI max pressure - longer life)	<b>G2G</b>	Flex-A-Thane® .187 ID, M-3 models only
	<b>Options (leave this blank for standard model)</b>		
<b>R</b>	Right facing pump head, input / output (Left facing fluid input / output is standard)		
<b>D</b>	Down facing pump head, input / output (Left facing fluid input / output is standard)		
<b>M - 4 2 4 - M N H</b>	<b>Sample Model Number</b>		

### Features list:

Features
TFD (Tube Failure Detection) System Alarm
FVS (Flow Verification System) Alarm - Requires Micro-Flo Sensor (sold separately)
10,000:1 turndown reversible motor.
Three position pump head rotation
Tube Life revolution counter with user programmable alarm set-point.
Set maximum motor RPM limit.
Power interruption re-start options.
Four output contacts can be triggered by the status of the TFD system, FVS system, general alarm, rotor direction, motor run/stop, revolution count, motor fail, remote/local setting, input signal failure, output signal failure, and currently active operating mode.
Output: One, 6 amp alarm relay
Output: Three, dry contact or maximum 30VDC/115VAC 1 amp contact closures
Output: Programmable 4-20mA signal or high speed pulse, proportional to pump output
Input: One, contact closure (remote start / stop)
Input: Remote speed control via 4-20mA, 0-10VDC, high speed digital pulse, contact closure pulse
Remote/Local control settings
Password protection
Display: Motor speed, Tube life revolutions, Tube Failure Detection (TFD) system and Flow Verification System (FVS) alarm status
Display: Output in ml/min, oz/min, L/hr, Gal/hr, Gal/day, RPM, and input signal values
Automated PPM chemical dosing system
Available Operating Modes:
Manual (local): speed adjustment
Remote input: 4-20mA
Remote input: 0-10 VDC
Remote input: high speed frequency (pulse) input
Remote input: pulse triggered batch dispensing
Remote input: proportional PPM (parts per million) dosing with high speed frequency (pulse) input
Manual (local): batch dispensing
Manual (local): repeating cycle timer
Manual (local): fixed speed PPM (parts per million) dosing

### Quick-Disconnect Valve Kits (Sold Separately)

For use with the Quick-Disconnect Flex-A-Prene Tube Assembly

¾" OD, ¼" Tubing		½" Hose Barb		½" M/NPT	
Part #	O-ring	Part #	O-ring	Part #	O-ring
KIT-QSV	FKM	KIT-QBV	FKM	KIT-QMV	FKM
KIT-QSE	EP	KIT-QBE	EP	KIT-QME	EP

Note: Quick-Disconnect valves are only available for M-2 and M-3 model pumps.



36 Hudson Rd  
Sudbury MA 01776

800-225-4616  
www.tisales.com

**Blue-White Industries, Ltd.** 5300 Business Drive, Huntington Beach, CA 92649  
Tel: 714-893-8529 Fax: 714-894-9492  
www.ProSeries-M.com Email: sales@blue-white.com

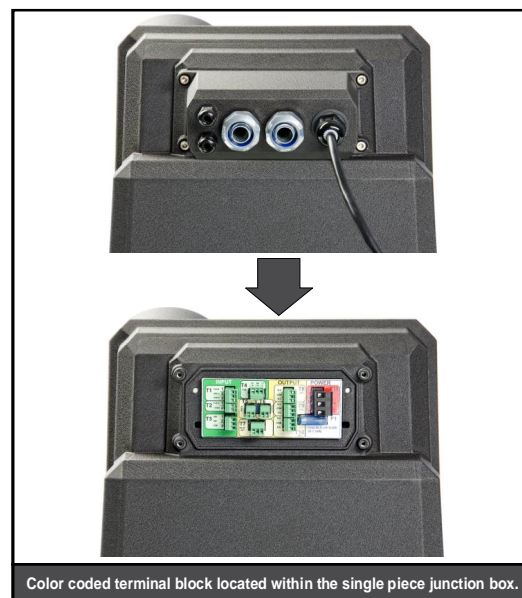

Color coded terminal block located within the single piece junction box.